

# Diaphragm seal in plastic material D030

Body in Polypropylene

EPDM membrane lined with PTFE

All plastic separators for measuring very aggressive fluids



## Characteristics

<b>Body</b>	PP (option other materials)
<b>Membrane</b>	EPDM lined with PTFE
<b>Connection</b>	Process: G 1/2 F Device: G 1/2 F or G 1/4 F
<b>Max. pressure</b>	+10 bar à 20°C
<b>Temperature</b>	+10 ... 80°C
<b>Compatibility with pressure gauges DN40 to DN160</b>	

## Dimensions

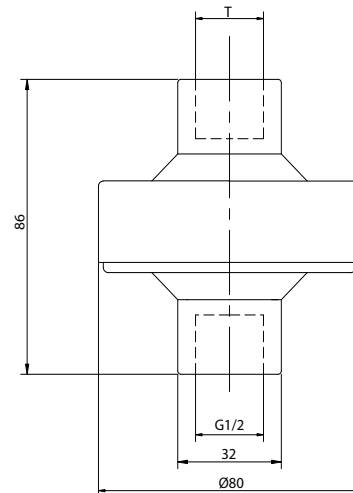

<b>T</b>
G 1/4
G 1/2

The D030 is incompatible with bellows pressure gauges and pressure switches

Max. operating temperature

Measurement range	PP	PVC (option)	PVDF (option)
0 ...2.5 bar	+10 ...80 °C	0 ...60°C	-30 ...120°C
0 ...4 bar	+10 ...70°C	0 ...50°C	-20 ...100°C
0 ...6 bar	+10 ...60°C	0 ...40°C	-20 ...100°C
0 ...10 bar	+10 ...40°C		-20 ...60°C

**Filling liquids** LRS2 silicone  
LRS7 glycerine

## Coding

		D030xL
<b>Type of separator</b>	1' ... 4' character	
D030		D030
<b>Top housing thread</b>	5' character	
G 1/4		H
G 1/2		L
<b>Bottom housing thread</b>	6' character	
G 1/2		L

UK/12-2007 This data sheet must only be copied complete