

Tongue Separator Series 1500

Tappet Connection

Application	Mounting to Bourdon tube pressure gauges or to pressure transmitters, for connection to measuring points with internal thread. Designed for pressure measurements for which the diaphragm separators of Series 1080 can not be employed. The flow of the medium can damage the tongue separator. This must be taken into consideration when determining the measuring point.
Execution	The separator is inseparably fixed with the pressure measuring instrument to a hydraulic measuring unit, either directly, via a cooling element or via a capillary tube of stainless steel.
Type of construction	Tongue separator, diaphragm with longitudinal starshaped profile, all parts made of stainless steel, welded.
Connection	DIN 3852 Type A
Temperature of medium	Up to 80 °C, other temperature limits on request
Hydraulic transmission fluid	Glycerin for direct mounting Almond oil (sweet) for capillary tube, others on request



Selection chart

Type	Material of separator body	Material of diaphragm tube	Material of bottom piece	External thread G	Ordering code
Tongue separator	Stainless steel 1.4571	Stainless steel 1.4571	Stainless steel 1.4571	G 3/4	1501
	Stainless steel 1.4571	Stainless steel 1.4571	Stainless steel 1.4571	G 1/2	1502
Temperature of medium (e. g. 100 °C)					9007/0100
Ordering example: DRO 100/811.133/075 / 1501 / 9007/0100					
<div style="display: flex; justify-content: space-between; align-items: flex-start;"> <div style="width: 60%; border-top: 1px solid black; border-right: 1px solid black; padding: 5px;"> <p style="margin: 0;">↑</p> <p style="margin: 0;">↑</p> <p style="margin: 0;">↑</p> </div> <div style="width: 35%; padding-left: 10px;"> <p style="margin: 0;">Temperatur of medium 100 °C</p> <p style="margin: 0;">Separator ordering code</p> <p style="margin: 0;">Pressure gauge (see data-sheet D1.131)</p> </div> </div>					

Dimensions

Dimension drawing

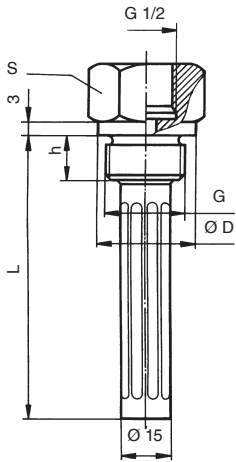

Dimension chart

G	h	ø D	L	S	Sealing ring
G 3/4	16	32	98	32	A27 x 32 DIN 7603
G 1/2	14	26	96	27	A21 X 26 DIN 7603

Pressure ranges (directive values)

Mounting to pressure gauge or pressure transmitter		NS 63	NS 80	NS 100	NS 160	Transmitter
Pressure ranges [bar] with thread-connection	G 3/4	¹⁾	2,5...400	6...1000	10...1000	4...1000
	G 1/2	¹⁾	2,5...400	6...1000	10...1000	

¹⁾ Only possible with transition piece G 1/4 female and G 1/2 male